



ASHFIELD BOYS HIGH SCHOOL NEWSLETTER

TERM 4 WEEK 9 2016

The last week for your diary

	Monday	Tuesday	Wednesday	Thursday	Friday
Week 10 12 - 16 Dec	<ul style="list-style-type: none"> • 7C - Team Day • 7D - Team Day 	<ul style="list-style-type: none"> • Maths Ext 2 Assessment • Yr 7 Science Waste Program- All day • Yr 12 English Standard & Advanced Task 	<ul style="list-style-type: none"> • Year 12 English Standard & Advanced Speaking task 	<ul style="list-style-type: none"> • Presentation Day-10am • Yr 12 English Standard & Advanced Task 	<ul style="list-style-type: none"> • Last day for Students

PRINCIPAL'S REPORT

Year 6 Orientation

We held a very successful Orientation day for Year on Tuesday. Parents had the opportunity to come to the school and meet staff while the boys had a small taste of high school. Even though I am sure that there is some remaining nervous energy that starting high school inevitable brings, hopefully the day lessened this anxiety – for kids and parents!

HSC Results BBQ

The HSC results are released next Thursday and individual ATARs are released on Friday. We will be holding our annual HSC BBQ for the boys on Friday 16th December. This is a great opportunity for the boys to celebrate and share their success. We would love to see all Year 12 there.

Presentation Day

Presentation day will be held on Thursday 15th December starting at 10am in the Gymnasium. All parents are welcome to attend. If your son is receiving an award he has a letter inviting you to attend. It may be a good idea to check in your son's bag to see if there is a letter there for you.

Evacuation Drill

We held our off site evacuation drill to Allman Park on Wednesday. We were supported as usual by the Police at Ashfield LAC who temporarily shut down Liverpool Road and Victoria Street for us. While the drill is a mandatory safety requirement, it also reinforces the amazing teamwork between staff and students that is a part of our school culture. The police were amazed that we managed to evacuate over 700 people from the site and cross Liverpool Road in 4 minutes, 19 seconds!

Dwayne Hopwood
Principal



117 Liverpool Rd, Ashfield
Tel: 9798 6620
Email: ashfieldbo-h.school@det.nsw.edu.au



EVACUATION DRILL



117 Liverpool Rd, Ashfield
Tel: 9798 6620
Email: ashfieldbo-h.school@det.nsw.edu.au



ORIENTATION DAY FOR YEAR 7

On Tuesday 6 December, Ashfield Boys High School hosted the Orientation Day for the students about to embark on their journey with us in 2017.

It was great to see so many new students and eager faces. I am sure the calm assurances of our 2017 Captain, our 2017 Vice Captain and two of our Year 7 students that Ashfield Boys is a great school were welcomed by the parents.

The students were able to experience classes in several faculties thanks to the teachers who organised and supervised the activities. Some of the boys attended a PE lesson, some worked with acids and alkalis in science, some did some wood and metalwork and some experienced a history lesson. By the accounts of the students on their return, they really enjoyed themselves.

It was a great morning and wonderful to meet so many new students. Thank you to the parents of our new Year 7 students for bringing them and thank you to the staff within our school that hosted their experience.



*Mandy Marks
Year 7 Advisor 2017*

P&C UPDATE

Thank you to everyone who contributed to the P&C this year, be it contributing to the levies fund which has raised approximately \$13,000, attending meetings and functions at the school as well as supporting fundraising activities like the election BBQ.

The P&C held its Annual General meeting in November. The executive remains the same: David Lewis, President, Louise Brooks & Rhonda Foreman, Vice Presidents, Tim Frost, Secretary and Christina Mandadakakis, Treasurer.

An Extraordinary General Meeting was also held in which a new constitution for the P & C was adopted. Its main points are that office bearers' terms are limited to 2 years; five attendees are required for a meeting quorum and we now pay 50c for voting rights. Also as per many organisations, new members can't vote for two meetings. The Constitution will be placed on the website if you want to look at it.

Have a happy and safe break. We have an exciting program coming up, including the welcome to Year 7 and the Film night competition. Notes about these events will come home with your son.

David Lewis and Louise Brooks



117 Liverpool Rd, Ashfield
Tel: 9798 6620
Email: ashfieldbo-h.school@det.nsw.edu.au



THE PROBABILITY SCALE



117 Liverpool Rd, Ashfield
Tel: 9798 6620
Email: ashfieldbo-h.school@det.nsw.edu.au



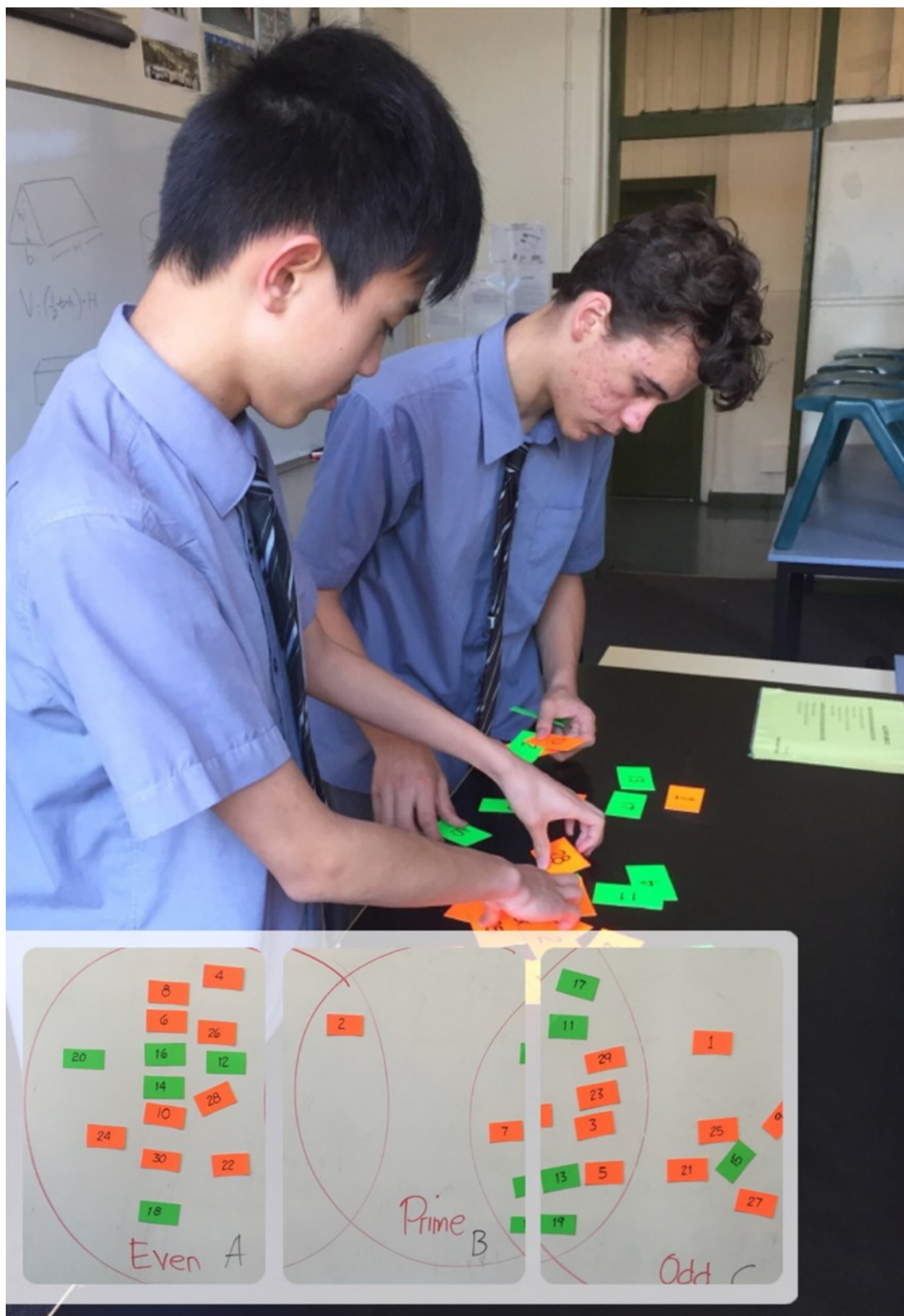

This Venn Diagram consisting of three circles helps students identify the shared features of three objects or ideas. This visual representation assists the students to organise similarities and differences before comparing and contrasting results.

Mr Tenefrancia
8 Apollo Mathematics Teacher



117 Liverpool Rd, Ashfield
Tel: 9798 6620
Email: ashfieldbo-h.school@det.nsw.edu.au



EXPLORING THE WORLD AROUND US

From the smallest of cells to the largest of volcanoes, Science students over the past few weeks have been investigating various phenomena in the world around them.

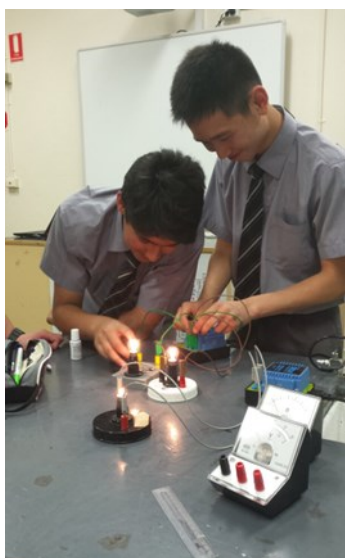

Year 8 has been exploring energy in all its forms, particularly the ways energy is used in their everyday lives. The students constructed electrical circuits and investigated the energy efficiency of light bulbs and other appliances. Working together, the students researched the energy transformations involved in everyday technologies and constructed creative solutions to make these more energy efficient.



In Year 9, the students have been investigating the movement of tectonic plates and the subsequent formation of volcanoes. Combining their knowledge of chemistry and geology, the students worked together to build models of volcanoes, even creating miniature explosions of “lava” to model volcanic eruptions.

Year 11 Biology has been investigating the transport of nutrients in plants and animals. The students sliced and stained celery stalks to create their own microscope slides, which they used to examine the xylem and phloem present in plants. They then dissected a kidney, identifying the key structures it is comprised of and tracing the pathway taken by blood through the organ.



The students thoroughly enjoyed these hands-on experiences, participating enthusiastically and working collaboratively with their peers.

*Marian Prasad
Science Teacher*



117 Liverpool Rd, Ashfield
Tel: 9798 6620
Email: ashfieldbo-h.school@det.nsw.edu.au



CREATIVE ART AND IDEAS IN MATHS

Where are CONGRUENT SHAPES seen in the real world?The kitchen, bathroom, old style verandahs, Islamic Art and much more.

A TESSELLATION uses congruent shapes in a repeated pattern with no gaps or overlaps.

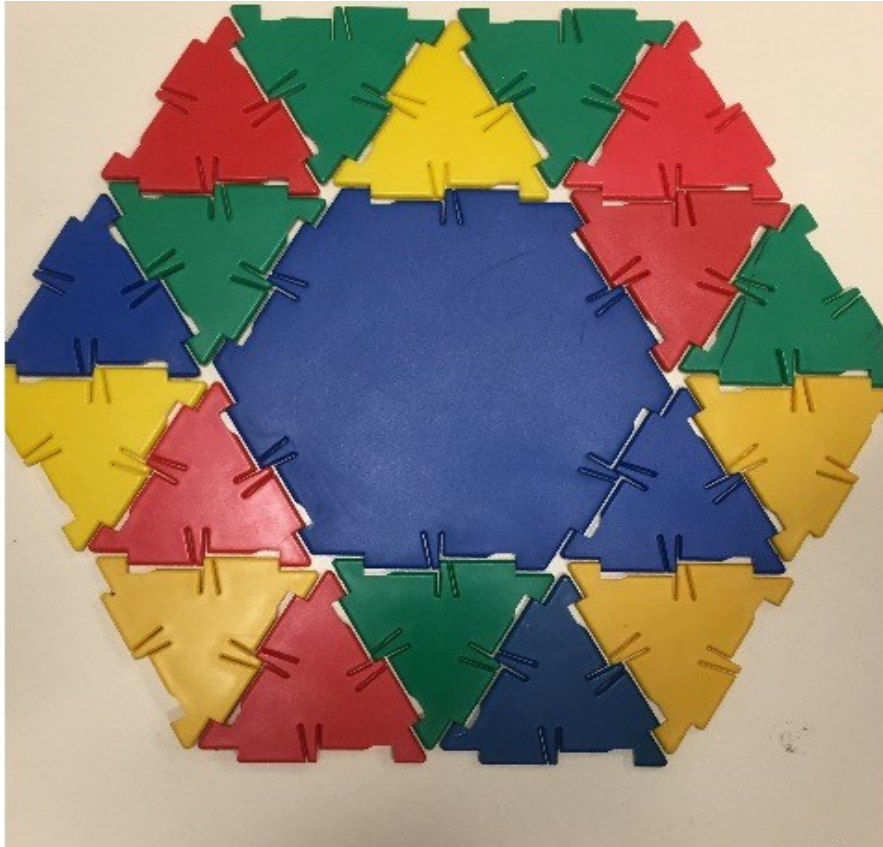

A tetrahedron inside a tetrahedron inside a tetrahedron.

Three polygons that tessellate: hexagon, triangle and square.

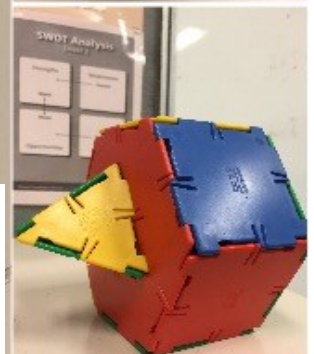

8 POSEIDON discovered that not all shapes tessellate.

Students tessellating tiles to begin with then..... the creativity took over as students tired of the 2D patterns and got creative building 3D solids. Here are a few.

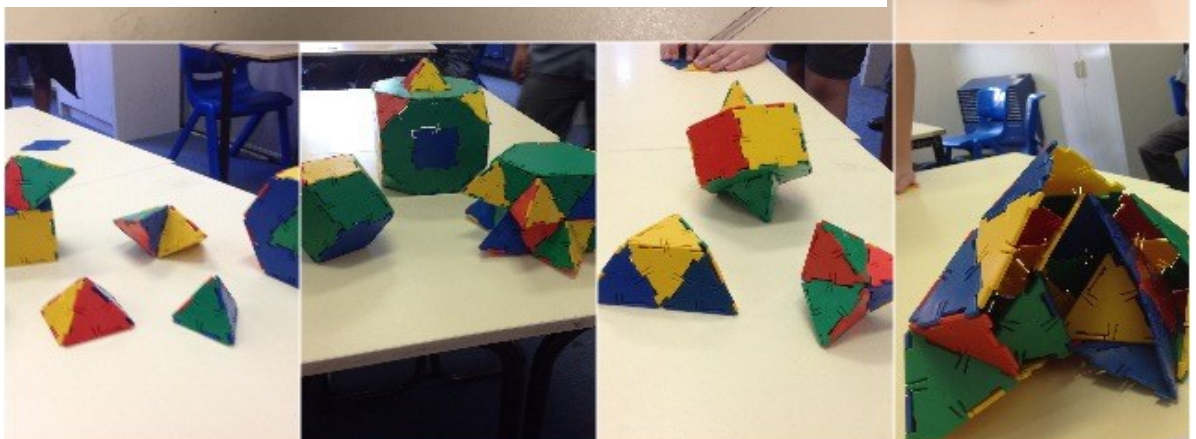

Pyramids, cubes, prisms and many interesting creations.

Maria Thomas - HT Computing/
Mathematics



117 Liverpool Rd, Ashfield
Tel: 9798 6620
Email: ashfieldbo-h.school@det.nsw.edu.au



MUSES ON MASCULINITY

Year 10 English students have been studying textual representations of masculinity this term. They have been looking at how the idea of the millennial male might differ from that of past generations, and making observations about the ways in which males and masculinity have been presented in media, film and literary texts.

As well as critical studies, the students of 10N wrote poems responding to the question- "What advice would you give to a younger male in your family or society?" Here is a sample from Harry Kang, inspired by his study of magazine covers targeting various male audiences.

Young Boys - Harry Kang

When young boys want to grow up,
Waiting for time to go by
They look up to role models in magazines
But little do they know it's all a lie
They look up to men who are all strong and buff
Young boys, only wishing they can become tough
But this is only a representation
You don't have to be the strongest in the nation.
You don't need to be flawless,
It's OK if you're a mess.
Just be who you are, because this life is a test.

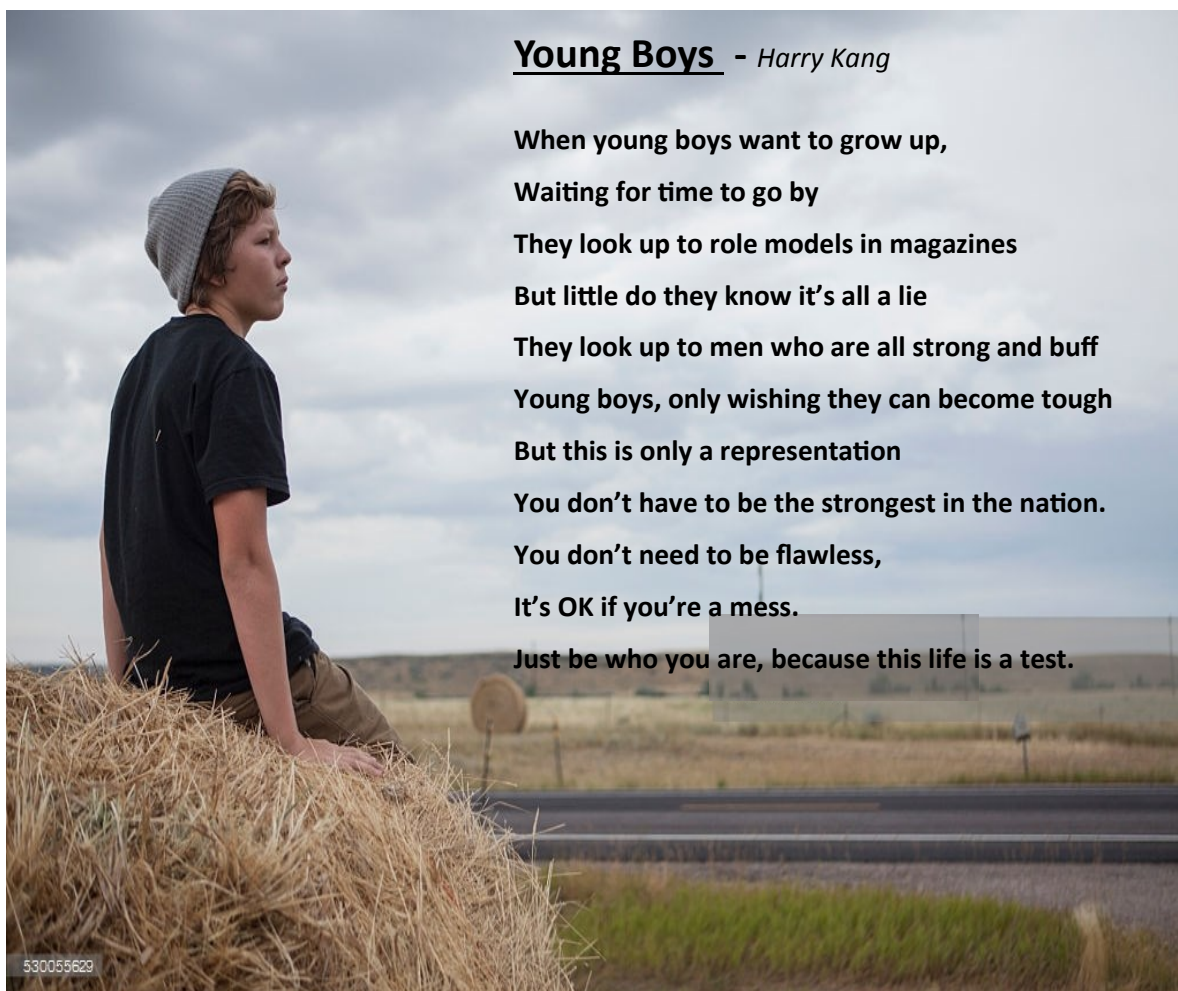

Year 10 English



117 Liverpool Rd, Ashfield
Tel: 9798 6620
Email: ashfieldbo-h.school@det.nsw.edu.au



VISUAL/GRAPHIC DESIGN

In Term 4, Visual / Graphic Design students used Adobe Photoshop to create special effects using fonts and images. For example, students attempted to patch up four different pictures and to remove certain elements. Microsoft Sway was used to provide explicit instructions on how to perform each task. Students also used Sway to collect, organise and display their completed tasks.

Example of Microsoft Sway.

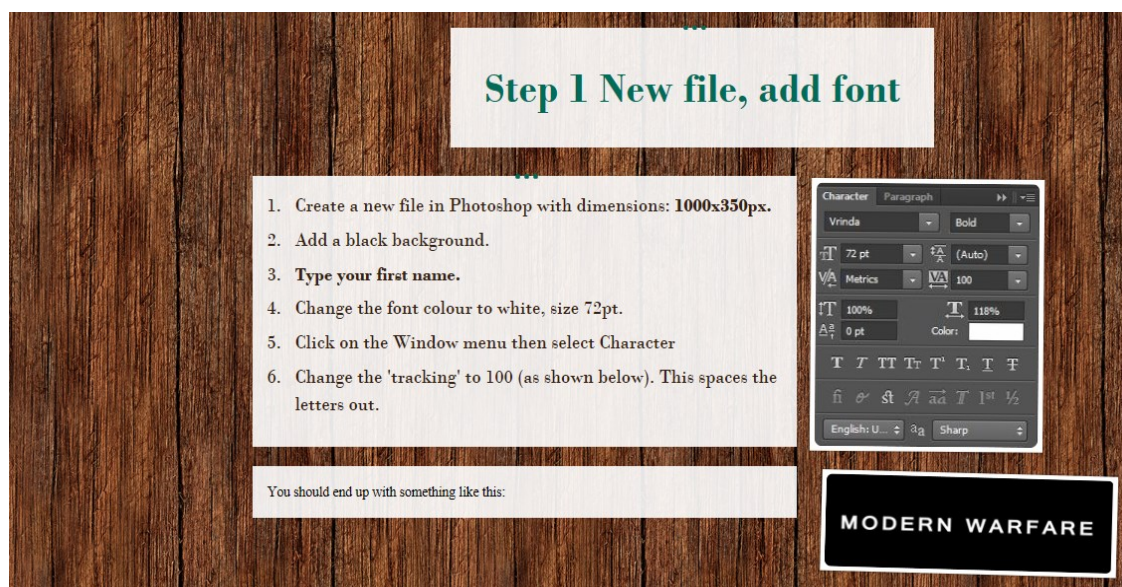

Before Photoshop



After Photoshop editing by Samed



We also created interesting fonts using Photoshop.

For example, **Ben** created a font effect similar to the font style used in the game "Call of Duty".



Mr Wenshuo Li
VGD Teacher



117 Liverpool Rd, Ashfield
Tel: 9798 6620
Email: ashfieldbo-h.school@det.nsw.edu.au



2016 SCHOOLS SPECTACULAR 'DREAM BIG'

The Ashfield Boys High School Vocal Group had a fantastic time performing as part of the Combined Choir in the 2016 Schools Spectacular on Friday 25 and Saturday 26 November 2016. In addition, Year 10 Music student George Brooks performed with the Millennium Marching Band. For the first time, Schools Spectacular was held at Qudos Bank Arena in Sydney Olympic Park and showcased the talents of over 5000 students from NSW Government Schools.

It was an amazing opportunity for our students to participate in such a large scale event and we look forward to auditioning for next year's Schools Spectacular.

Mrs Markou and Mr Milic



117 Liverpool Rd, Ashfield
Tel: 9798 6620
Email: ashfieldbo-h.school@det.nsw.edu.au



8Z @ 9D CINEMA



Students experienced the exciting 3D animated movies with surround sound, coupled with “active motion”, luxury seats and dramatic effects.



117 Liverpool Rd, Ashfield
Tel: 9798 6620
Email: ashfieldbo-h.school@det.nsw.edu.au



A DAY AT THE MUSEUM



Students enjoyed the displays open in the Permanent Galleries and the Wharf 7 Heritage Centre at the Australian National Maritime Museum.

The team also visited the Australian built replica of James Cook's HMB Endeavour.



117 Liverpool Rd, Ashfield
Tel: 9798 6620
Email: ashfieldbo-h.school@det.nsw.edu.au



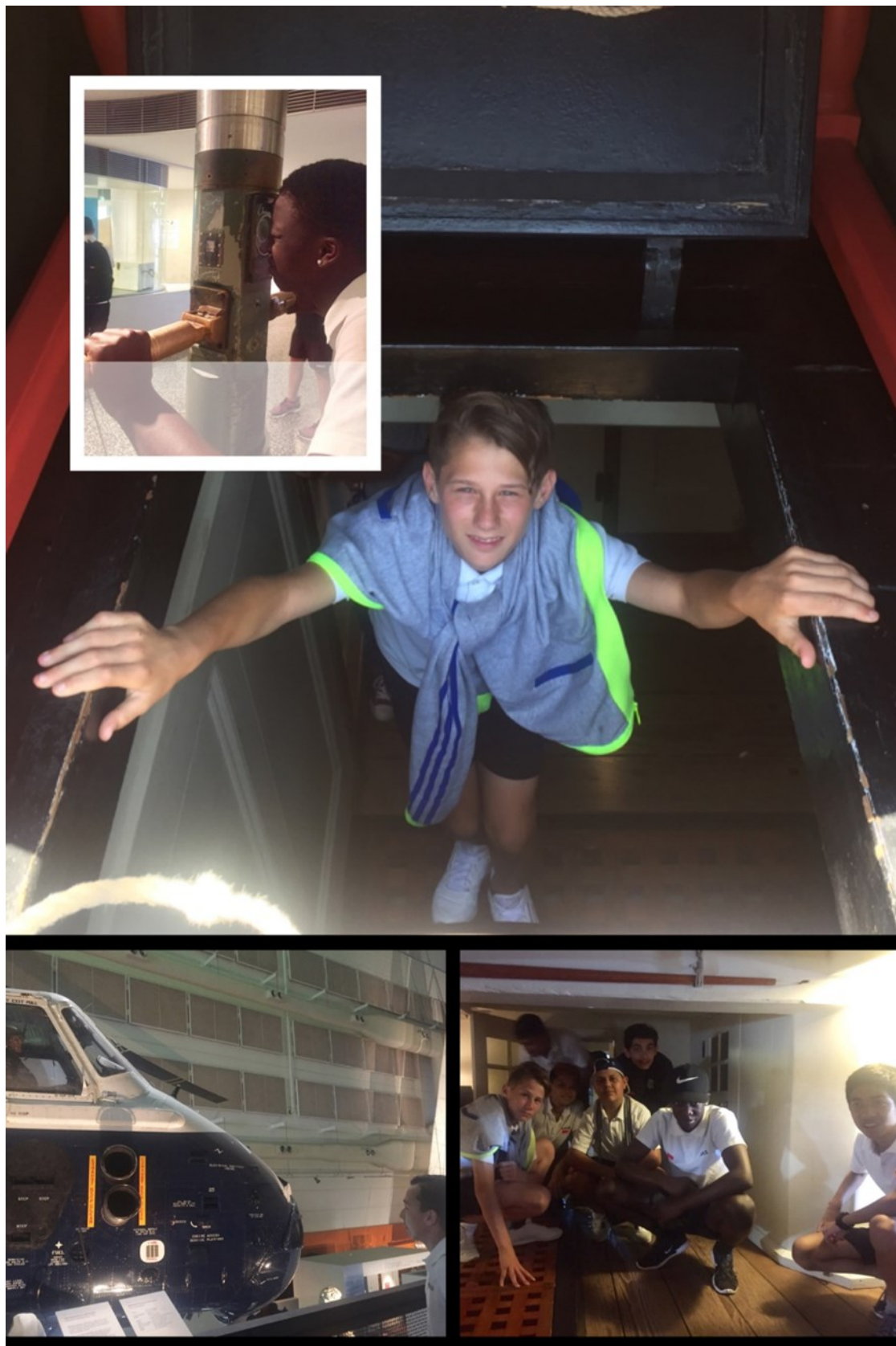

*Mr Tenefrancia
Ms Smit*



117 Liverpool Rd, Ashfield
Tel: 9798 6620
Email: ashfieldbo-h.school@det.nsw.edu.au



AUSTRALIAN BUSINESS WEEK

During Week 8, the Commerce classes of Year 10 joined Canterbury Girls for the Annual Australian Business Week. We were allocated teams in respective areas of the hall and we had to manage an electronic store virtually and physically for a simulated eight quarters. All the boys were really excited and eager to partake in something different. We arrived at the school on Monday 28th November, ready for the five days that lay ahead of us. The groups contained on average two boys and ten girls. The first day was predominately arranging roles and kick-starting everyone's business. We had to find people's strengths in order for the business to be as successful as possible. Even after the first day we became really close with a lot of the Canterbury Girls and that made our transition much easier. Every day there was team building activities that took the stress out of running our businesses and gave us all a bit of a laugh. For example each group had to dress two volunteers into a bride's dress and a groom's suit and out of toilet paper. Most boys assumed the role of the groom except for Jimmy who courageously wore a toilet paper wedding dress.



At the end of each day we had a strict set of tasks that needed to be accomplished and for our business to run smoothly and be finished by Friday we had to complete all tasks by the deadline.

Each business comprised three teams- financial, marketing and operations. The CEO or Assistant CEO had to monitor each team's progression. The financial team was responsible for completing



eight decision sheets over four days which determined our revenue, market value, stock turn and

return on assets. They also had to decide how much to purchase and sell our products for. The marketing team had to decide our products and also come up with each group's unique selling proposition. The operations team had to create our trade display which would be inspected on Friday by judges.

As days went by, the work started to pile up and this whole simulation taught us the stresses of running a business. The obstacles that we had to overcome as a team and all the tasks we were required to do. After a few near sleepless nights, Friday came and all groups had to have their company report, oral presentation and trade displays ready for judging.



117 Liverpool Rd, Ashfield
Tel: 9798 6620
Email: ashfieldbo-h.school@det.nsw.edu.au





117 Liverpool Rd, Ashfield
 Tel: 9798 6620
 Email: ashfieldbo-h.school@det.nsw.edu.au



After a strenuous five days despite several fun moments and group chats when we were supposed to be working, the last day arrived. The computer simulation made up 30%, the trade display, commercial, oral presentation and company reports made up 15% of the group's total mark. At the same time we were glad it was the last day, we were sad that we reached the end and we had to go back to school the next week. The judges had a strict criteria to determine everyone's placing in the respective aspects of each business. In the trade display we had to convince the judges to buy our USP and highlight the marketing aspects of our companies. The oral presentations were a tedious few hours however, we were given pizza and drinks at the end.



The awards presentation arrived and surprisingly my company Jetech won the overall competition. It was a great end to the experience but we all won in the end. We all made a lot of friends and had a few laughs as well. It was a rewarding experience and all teachers who organised the event and allowed us to participate should be congratulated. Most of us felt the effects after the presentation, although I am sure all the boys would want to go back and do it again.



117 Liverpool Rd, Ashfield
Tel: 9798 6620
Email: ashfieldbo-h.school@det.nsw.edu.au





Paul Elliot (CEO), Angela Assistant CEO) and Mrs Smit (Mentor)



Stella (CEO), Quoc Anh Do (Assistant CEO) Mr Burford & Ms Skelton (Mentors)



Jordan Nicolopoulos Yr10 Ms Skelton & Ms Smit



117 Liverpool Rd, Ashfield
Tel: 9798 6620
Email: ashfieldbo-h.school@det.nsw.edu.au



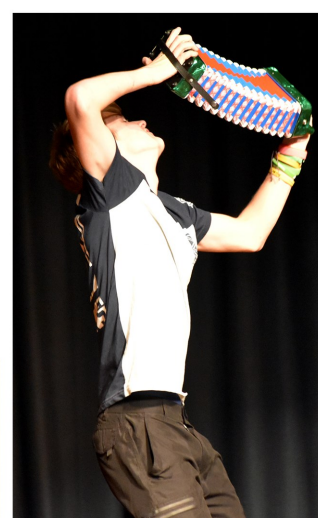

CREATIVE ARTS NIGHT



117 Liverpool Rd, Ashfield
Tel: 9798 6620
Email: ashfieldbo-h.school@det.nsw.edu.au





MUSIC.

ART.

DRAMA



117 Liverpool Rd, Ashfield
 Tel: 9798 6620
 Email: ashfieldbo-h.school@det.nsw.edu.au





READERS REWARDED WITH FANTASTIC BEASTS

On Friday 2nd December there was a reward excursion for the boys who had consistently met their targets in the reading program. The boys chose to see “Fantastic Beasts and Where To Find Them”, based on the book by J. K. Rowling.

It was a great film and the boys loved it. To quote Yong Bo Ma it was “exactly wonderful”. One of the bus drivers complimented the boys’ behaviour and a member of the public at the cinema emailed us saying they were a credit to the school, as indeed they were.

Ms Mitchell.



Before the movie.



After the movie.



117 Liverpool Rd, Ashfield
Tel: 9798 6620
Email: ashfieldbo-h.school@det.nsw.edu.au



MEET NICHOLAS THROUGH THE SPECTRUM OF PERSONAL INTERESTS

As an athlete, Nicholas Beekwilder represented our school at State and National levels. Apart from his natural ability to learn and perform different athletic skills with ease, his success was hard-earned. Nicholas trains 5- 6 days a week, completing a total of 7-12 training sessions weekly. Four days a week he wakes up at 5:29 am to practise Javelin, long distance running and core strength.

As the end of yet another successful year is fast approaching, Nicholas was kind enough to share his interests, thoughts offering an insight into the mind of Ashfield's most prolific athlete.



Favourite food/drink: Beef burger/ sprite
 Car: Volkswagen Kombi
 Preferred music style: Skepta
 Clothing designer: Nike
 Footwear: Slides
 The book: The Great Gatsby
 Flower: Lily
 Domestic/international sports team:
 Newcastle Knights/ Netherlands Football
 team
 Dream: To become an Olympian
 Dream girl: Tall, black hair, brown eyes,
 gorgeous smile
 Frustration: Peaking at the wrong time
 Shampoo: Head and shoulders
 Dance: Salsa
 Deodorant: Lynx
 Leisure activity: Fishing and watching comedy
 movies
 Motto: "Back yourself"
 Favourite Holiday destination: Netherlands
 Source of Motivation: Invisible self and other
 prolific athletes
 Christmas wish: Stay healthy and injury free

PDHPE Faculty: Our students - our treasure!



117 Liverpool Rd, Ashfield
 Tel: 9798 6620
 Email: ashfieldbo-h.school@det.nsw.edu.au





School Term Dates 2017

The summer holidays are just around the corner, but we know that teachers, parents, caregivers and students can never be too prepared!

Here is a handy list of the NSW Department of Education's school term dates for 2017. Teachers return to school for Staff Development Day on Friday 27 January.

Don't forget to jot these essential dates in the diary:

Term 1 - Monday, 30 January to Friday, 07 April

Term 2 - Wednesday, 26 April to Friday, 30 June

Term 3 - Tuesday, 18 July to Friday, 22 September

Term 4 - Monday, 09 October to Tuesday, 19 December

Please check with your school as these dates may vary in some circumstances.



117 Liverpool Rd, Ashfield
Tel: 9798 6620
Email: ashfieldbo-h.school@det.nsw.edu.au



14th December 2016 - Grade Sport Organisation

Assembly Point	Sport	Venue	Opposition	Coach	Leave class at:	Assemble and Sit at:	Game Time
A	Basketball 1st	ABHS Gym	BYE	Dobrowolski		12:34	13:45
A	Basketball 2nd	ABHS Gym	BYE	Dobrowolski		12:34	13:00
B	Basketball U15's	ABHS Gym	BYE	Tyler		12:34	13:45
B	Basketball U14's	ABHS Gym	BYE	Tyler		12:34	13:00
D	Cricket Open 2nds	Hammond	BYE	Carrington Burns		12:34	13:00
E	Cricket U14's	Hammond	BYE	Markou Richardson		12:34	13:00
I	Futsal 1 st	Hammond	BYE	Phillips		12:34	13:30
I	Futsal 2nds	Hammond	BYE	Phillips		12:34	13:00
M	Futsal U15's A	Hammond	BYE	Chu		12:34	14:30
M	Futsal U15's B	Hammond	BYE	Chu		12:34	14:00
N	Oztag 1 st	Ashfield Park	BYE	Chatwin		12:34	13:45
N	Oztag 2nds	Ashfield Park	BYE	Beretin		12:34	13:00
O	Oztag U15's A	Ashfield Park	BYE	Lam		12:34	13:45
O	Oztag U15's B	Ashfield Park	BYE	Belle-Page		12:34	13:00
P	Volleyball 1 st	BYE	BYE	Boshell		12:34	13:45
P	Volleyball 2nds	BYE	BYE	Boshell		12:34	13:00

						Start	Finish
Z	Sick or Injured With Note	F5		Reid	Assemble at 12:30	12:30	2:30



117 Liverpool Rd, Ashfield
Tel: 9798 6620
Email: ashfieldbo-h.school@det.nsw.edu.au



RECREATIONAL SPORT - WEEK 18						
Assembly Point	Sport	Venue	Coach	Assemble and Sit in Year 7 quad at:	Start Time	Finish Time
1	Badminton OP	Olympic Park	Hathi	12:05	12:34	2:31
2	Volleyball OP	Olympic Park Basketball Court	Zhang	12:34	12:34	2:31
3	Futsal OP	TBA	Tenefrancia	12:34	12:34	2:31
4	Table Tennis OP	Year 7 Area	Yoon	12:34	12:34	2:31
14	Football (Soccer)	ABHS Oval	Mahmud	12:34	12:34	2:31
5	Power Walk	Ashfield Local Area	Jones Museth	12:34	12:34	2:31
8	Multi-Sport	ABHS Oval	Nasour Wei	12:34	12:34	2:31
6	Power Yoga	F2/F3	Marks	12:34	12:34	2:31
15	Outdoor Fitness	Ashfield Park	Pool Zubac	12:34	12:34	2:31
13	Basketball Years 9-10	Centenary Park	Fasan Jovicic	12:34	12:34	2:31
7	Swimming	Ashfield Pool	Curran Zimaras	12:34	12:34	2:31
10	Table Tennis ABHS	ABHS Hall/ Year 7 Quad	Smit	12:34	12:34	2:31
12	Theatre Sport	D9	Whitting	12:34	12:304	2:31
Z	Sick or injured With Note	F5	Reid	12:34	12:34	2:31

Futsal – Olympic Park Sports Centre booking times:

3,10,17,24,31 August
7(Hall),14 September
12,19,26 October
9,16,23(Hall)November

Volleyball - Olympic Park Sports Hall booking times:

3,10,17,24,31 August
7,14,21 September
12,19,26 October
2,9,16,23 November

Table Tennis- Olympic Park Sports Hall booking times:

3,10,17,24,31 August
7,14, 21 September
12,19,26 October
2, 9,16,23 November

Badminton - Olympic Park NSW Netball

Unavailable dates:



117 Liverpool Rd, Ashfield
Tel: 9798 6620
Email: ashfieldbo-h.school@det.nsw.edu.au



7. For students who have lost , Faulty or had their Opal Card Stolen

To replace Lost or Stolen Opal Cards go online at

www.transportnsw.info/school-students

And apply for a replacement Opal Card.

NB: Students are required to pay a fare whilst waiting for delivery of new Opal Card.

8. For students not eligible for free school travel

Log online at www.transportnsw.info/school-students and purchase a School Term Bus Pass.

9. Student Travel Eligibility

To be eligible for subsidised travel under the SSTS, school students must be:

An infant student; i.e. attending Kindergarten, Year 1 or Year 2 classes, irrespective of the distance from home to school; or

a primary student (Year 3-6), and reside more than 1.6 kilometres (straight line distance) from the school attended, measured from the centre of the school site, or 2.3 kilometres or more by the most direct practicable walking route to the nearest point of physical entry to the school; or

a secondary student (Year 7-12), and reside more than 2.0 kilometres (straight line distance) from the school attended, measured from the centre of the school site, or 2.9 kilometres or more by the most direct practicable walking route to the nearest point of physical entry to the school;

Parents/guardians of students deemed ineligible by their school or local transport operator on straight line distance grounds may apply to TfNSW for a review of the determination on walking distance or pedestrian safety grounds.

Should TfNSW, after carrying out the review, not approve subsidised travel and the applicant (s) considers that there are special circumstances, such as pedestrian safety and/or hardship issues associated with their case; they may appeal the TfNSW decision.

Appeals are heard by an independent SSTS Appeals Panel which considers each case on its individual merits.

For more information www.transportnsw.info/school-students



117 Liverpool Rd, Ashfield
Tel: 9798 6620
Email: ashfieldbo-h.school@det.nsw.edu.au



A SHORT FILM COMPETITION FOR PARTICIPATING SCHOOLS IN THE INNERWEST

A P&C INITIATIVE | CANTERBURY GIRLS HIGH SCHOOL

BEing Human

shortFilmfestival

Explore and celebrate what we all have in common: Being Human

Enter your 1 to 5 minute film for a chance to win great prizes and your film could be shown in New York at a special screening of finalists in support of 108lives.org

ENTRIES CLOSE 6 MARCH 2017

ASHFIELD BOYS HIGH SCHOOL FINAL

26 MARCH 2016 @ FILM AND MUSIC CELEBRATION

INTER-SCHOOL GRAND FINAL

6 APRIL 2017 @ CANTERBURY GIRLS HIGH SCHOOL

Use your film to share and promote ideas of human commonality, compassion and understanding. Did we mention you can win stuff?

1st and 2nd place winners from each school's mini festival go into the grand final to be held at Canterbury Girls High School on 6 April 2017

email info@beinghumanfilmfestival.com

www.beinghumanfilmfestival.com

How to Enter

Go to: www.beinghumanfilmfestival.com

1. Read the terms and conditions and guidelines then make your film
2. Upload to YouTube or Vimeo
3. Complete the online registration form



117 Liverpool Rd, Ashfield
Tel: 9798 6620
Email: ashfieldbo-h.school@det.nsw.edu.au





IMPORTANT INFORMATION REGARDING OPAL CARDS

1. For students entering year 11 at a New School

At the End of this year you will need to go online at

www.transportnsw.info/school-students

And update your information to “New School”. Print the 2 page document, sign and return to the Administration Office of your New School.

2. For students entering year 11 at a Current School

At the End of this year you will need to go online at

www.transportnsw.info/school-students

And update your information to “Year 11”. Print the 2 page document, sign and return the Administration Office of your School.

3. For students entering year 7 at a New School

At the End of this year you will need to go online at

www.transportnsw.info/school-students

And update your information to “New School”. Print the 2 page document, sign and return to the Administration Office of your New School.

4. For students entering year 7 at Current School

At the End of this year you will need to go online at

www.transportnsw.info/school-students

And update your information to “Year 7”. Print the 2 page document, sign and re turn to the Administration Office of your School.

5. For students entering year 3

At the End of this year you will need to go online at

www.transportnsw.info/school-students

And update your information to “Year 3”. Print the 2 page document, sign and return to the School Administration Office.

6. For New Enrolments

For Students who don’t have a school Opal Card or are Starting Kindergarten go online at www.transportnsw.info/school-students

And apply for a School Travel Pass. Print the 2 page document, sign and return to the School Administration Office.



117 Liverpool Rd, Ashfield
Tel: 9798 6620
Email: ashfieldbo-h.school@det.nsw.edu.au



7. For students who have lost , Faulty or had their Opal Card Stolen

To replace Lost or Stolen Opal Cards go online at

www.transportnsw.info/school-students

And apply for a replacement Opal Card.

NB: Students are required to pay a fare whilst waiting for delivery of new Opal Card.

8. For students not eligible for free school travel

Log online at www.transportnsw.info/school-students and purchase a School Term Bus Pass.

9. Student Travel Eligibility

To be eligible for subsidised travel under the SSTS, school students must be:

An infant student; i.e. attending Kindergarten, Year 1 or Year 2 classes, irrespective of the distance from home to school; or

a primary student (Year 3-6), and reside more than 1.6 kilometres (straight line distance) from the school attended, measured from the centre of the school site, or 2.3 kilometres or more by the most direct practicable walking route to the nearest point of physical entry to the school; or

a secondary student (Year 7-12), and reside more than 2.0 kilometres (straight line distance) from the school attended, measured from the centre of the school site, or 2.9 kilometres or more by the most direct practicable walking route to the nearest point of physical entry to the school;

Parents/guardians of students deemed ineligible by their school or local transport operator on straight line distance grounds may apply to TfNSW for a review of the determination on walking distance or pedestrian safety grounds.

Should TfNSW, after carrying out the review, not approve subsidised travel and the applicant (s) considers that there are special circumstances, such as pedestrian safety and/or hardship issues associated with their case; they may appeal the TfNSW decision.

Appeals are heard by an independent SSTS Appeals Panel which considers each case on its individual merits.

For more information www.transportnsw.info/school-students



117 Liverpool Rd, Ashfield
Tel: 9798 6620
Email: ashfieldbo-h.school@det.nsw.edu.au

